

WEST SUSSEX COUNTY COUNCIL
((CRAWLEY BOROUGH) (PARKING PLACES AND TRAFFIC REGULATION)
(CONSOLIDATION) ORDER 2010)
(TOWN CENTRE AMENDMENT) ORDER 2015

CRAWLEY: LOCATION OF WAITING RESTRICTIONS

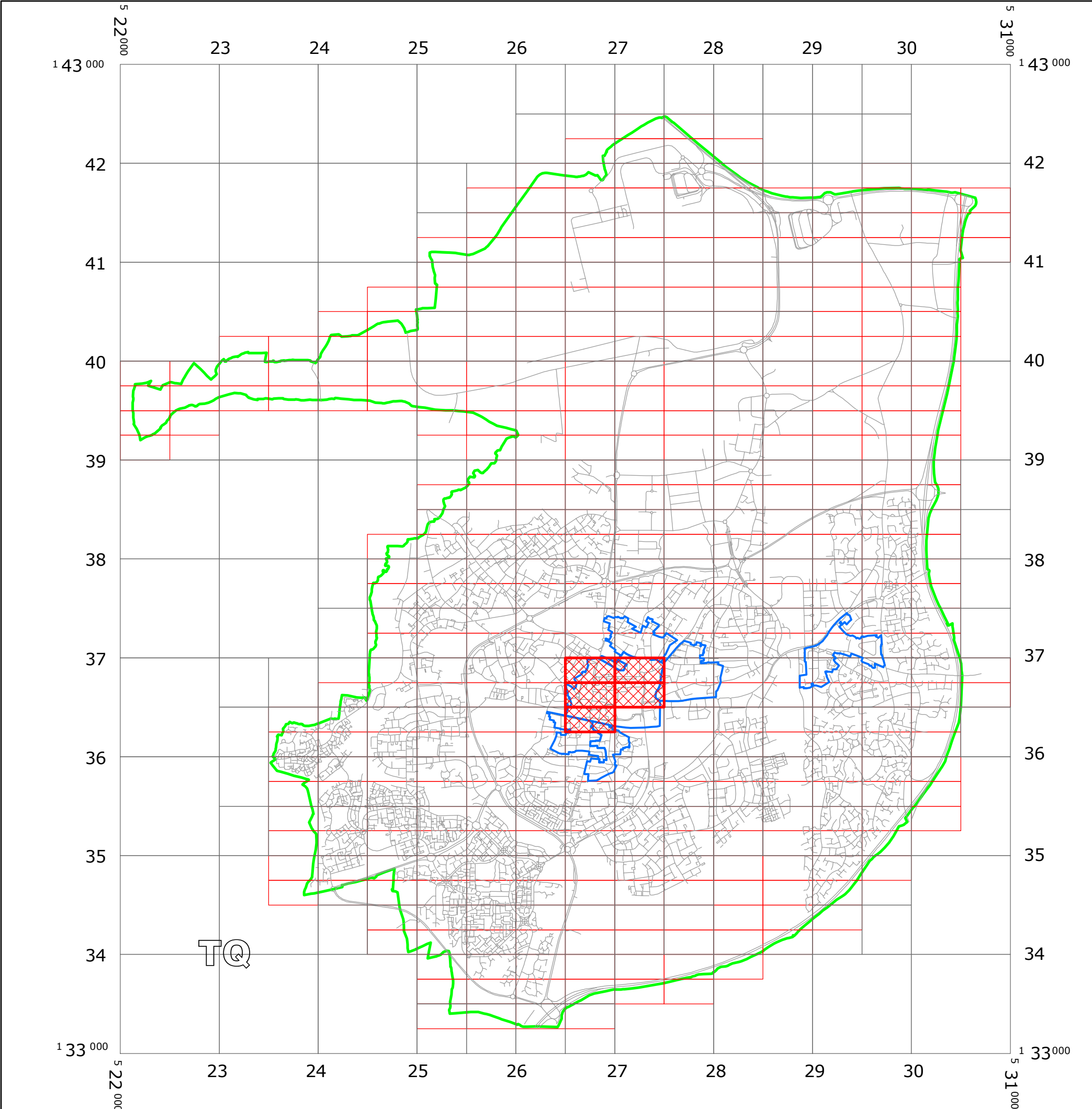

KEY:

OS TILE GRID

PARKING TILE GRID

LOCATION OF WAITING RESTRICTIONS

PARISH BOUNDARY

CONTROLLED PARKING ZONE BOUNDARY

ROAD NETWORK



West Sussex County Council
Communities & Infrastructure
The Grange
Tower Street
Chichester
West Sussex
PO19 1RH

WEST SUSSEX COUNTY COUNCIL
((CRAWLEY BOROUGH) (PARKING PLACES AND TRAFFIC REGULATION)
(CONSOLIDATION) ORDER 2010)
(TOWN CENTRE AMENDMENT) ORDER 2015

LOCATION OF WAITING RESTRICTIONS

Reproduced from or based upon 2013 Ordnance Survey material with permission of the Controller of HMSO
(c) Crown Copyright reserved. Unauthorised reproduction infringes Crown copyright and may lead to
prosecution or civil proceedings West Sussex County Council Licence No. 100023447

SCALE: 1:40,000
DATE: 18/05/2015



Key for Waiting Restrictions

All areas over which the provision of the orders apply are defined by the shaded areas as shown on the following plans plus a contiguous area not indicated on the plans of verge and/or footway between the carriageway edge and the highway boundary. The plans in this schedule are based upon grid references of the Ordnance Survey National Grid defined by the OSGB 36 triangulation.

Prohibition of waiting at any time

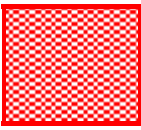
100		z_circle	No waiting, loading and unloading at any time
101		check	No waiting at any time

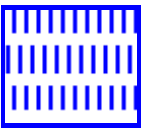
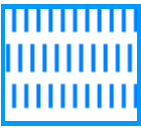
111		pat 046	No waiting 9.00am-5.00pm Mon–Sat
158		pat 046	No waiting 9.00am-5.00pm Mon–Sat except bank holidays

Prohibition of loading

219		usgs504	No waiting at any time, No loading and unloading 10.00am-4.00pm any day
225		usgs401	No waiting at any time, No loading and unloading 10.30am-4.00pm Mon-Sat

Charged on-street parking

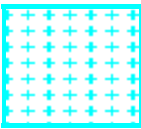
309		tic2	Pay and Display up to 1hr 9.00am-5.00pm Mon-Sat Tariff 9
-----	---	------	--

Residents Parking

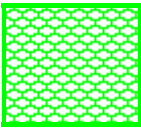
512		usgs503	Residents’ and Visitors’ permit holders only 9.00am-5.00pm Mon-Sat except bank holidays
-----	---	---------	---

Shared Residents Parking & Free Limited Waiting

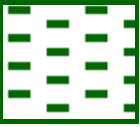

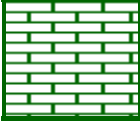
610		pat063	Residents' and Visitors' permit holders and Limited waiting for 1hr No return within 1hr for non-permit holders 9.00am-5.00pm Mon–Sat except bank holidays
614		pat019	Residents' and Visitors' permit holders and Limited waiting for 2hrs No return within 2hrs for non-permit holders 9.00am-5.00pm Mon–Sat except bank holidays

624		pat062	Residents' and Visitors' permit holders and Limited waiting for 20mins No return within 20mins for non-permit holders 9.00am-5.00pm Mon-Sat except bank holidays
-----	---	--------	--

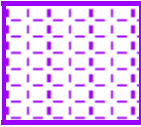
Free Limited Waiting

707		pat020	Waiting limited to 1hr No return within 1hr 9.00am-5.00pm Mon–Sat
740		usgs401	Waiting limited to 2hrs No return within 2hrs 9.00am-5.00pm Mon-Sat except bank holidays

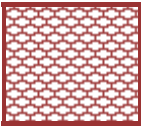
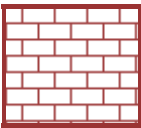
Specified Vehicles

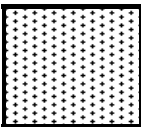
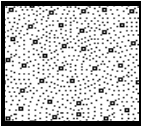
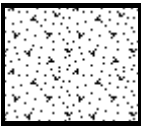
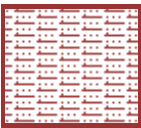
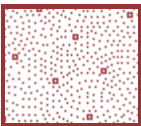
802		pat038	Disabled persons vehicles 9.00am-5.00pm Mon-Sat
810		usgs503	Loading bay-Goods vehicles only at any time
814		brick1	Loading bay-Any vehicle at any time
830		check	Disabled persons vehicles at any time
844		usgs721	No stopping at any time except taxis
845		usgs602	No waiting at any time except taxis
849		usgs723	Motor cycles only 9.00am-5.00pm Mon-Sat
880		usgs617	Loading bay-Any vehicle at any time Loading limited to 40mins No return within 40mins
893		usgs601	Loading bay-Goods vehicles only 6.00am-10.00pm and No stopping except taxis 10.00pm-6.00am any day

 Boundary of Controlled Parking Zone

WEST SUSSEX COUNTY COUNCIL
((CRAWLEY BOROUGH) (PARKING PLACES AND TRAFFIC REGULATION)
(CONSOLIDATION) ORDER 2010)
(TOWN CENTRE AMENDMENT) ORDER 2015

West Sussex County Council in exercise of their powers under Sections 1 (1) 2 (1) and (2), 4 (2), 45, 46, 49 and 53 and Part IV of Schedule 9 of the Road Traffic Regulation Act 1984 "the Act" as amended and of all other enabling powers and after consultation with the chief officer of police in accordance with Part III of Schedule 9 to the Act hereby make the following Order:-

1. This Order shall come into operation on the 18th day of May 2015 and may be cited as "West Sussex County Council ((Crawley Borough) (Parking Places and Traffic Regulation) (Consolidation) Order 2010) (Town Centre Amendment) Order 2015."
2. The "West Sussex County Council (Crawley Borough) (Parking Places and Traffic Regulation) (Consolidation) Order 2010" is hereby amended by;-
 - (i) the deletion from it of the plans specified in the First Schedule to this Order; and
 - (ii) the substitution of the plans attached in the Second Schedule to this Order; and
 - (iii) the addition to Item 3 Tariff 9 of the Second Schedule of the Order, of the Charges and Tariffs in the Third Schedule to this Order.

FIRST SCHEDULE
Plans to be deleted

TQ2636NEN (Sheet Issue No. 3)
 TQ2636NES (Sheet Issue No 3)
 TQ2636SEN (Sheet Issue No. 2)
 TQ2736NWN (Sheet Issue No. 2)
 TQ2736NWS (Sheet Issue No.2)

SECOND SCHEDULE
Plans to be substituted
(as attached)

TQ2636NEN (Sheet Issue No. 4)
 TQ2636NES (Sheet Issue No 4)
 TQ2636SEN (Sheet Issue No. 3)
 TQ2736NWN (Sheet Issue No. 3)
 TQ2736NWS (Sheet Issue No.3)

THIRD SCHEDULE
Charges & Tariffs

The Boulevard (NW Service Road)
Tariff 9

Time	Tariff
Upto 30 minutes	70p
Upto 1 hour	£1.40

THE COMMON SEAL of WEST SUSSEX
COUNTY COUNCIL was hereto affixed

the TWELFTH day of MAY 2015
in the presence of:

M. Kershaw

Authorised Signatory

)
)
)
)
) (L.S)
)
)
)



I HEREBY CERTIFY THIS TO
BE A TRUE COPY OF THE
ORIGINAL DOCUMENT

Tony Kershaw

.....
Authorised Officer

WEST SUSSEX COUNTY COUNCIL

cc/cb DELEGATED AUTHORITY

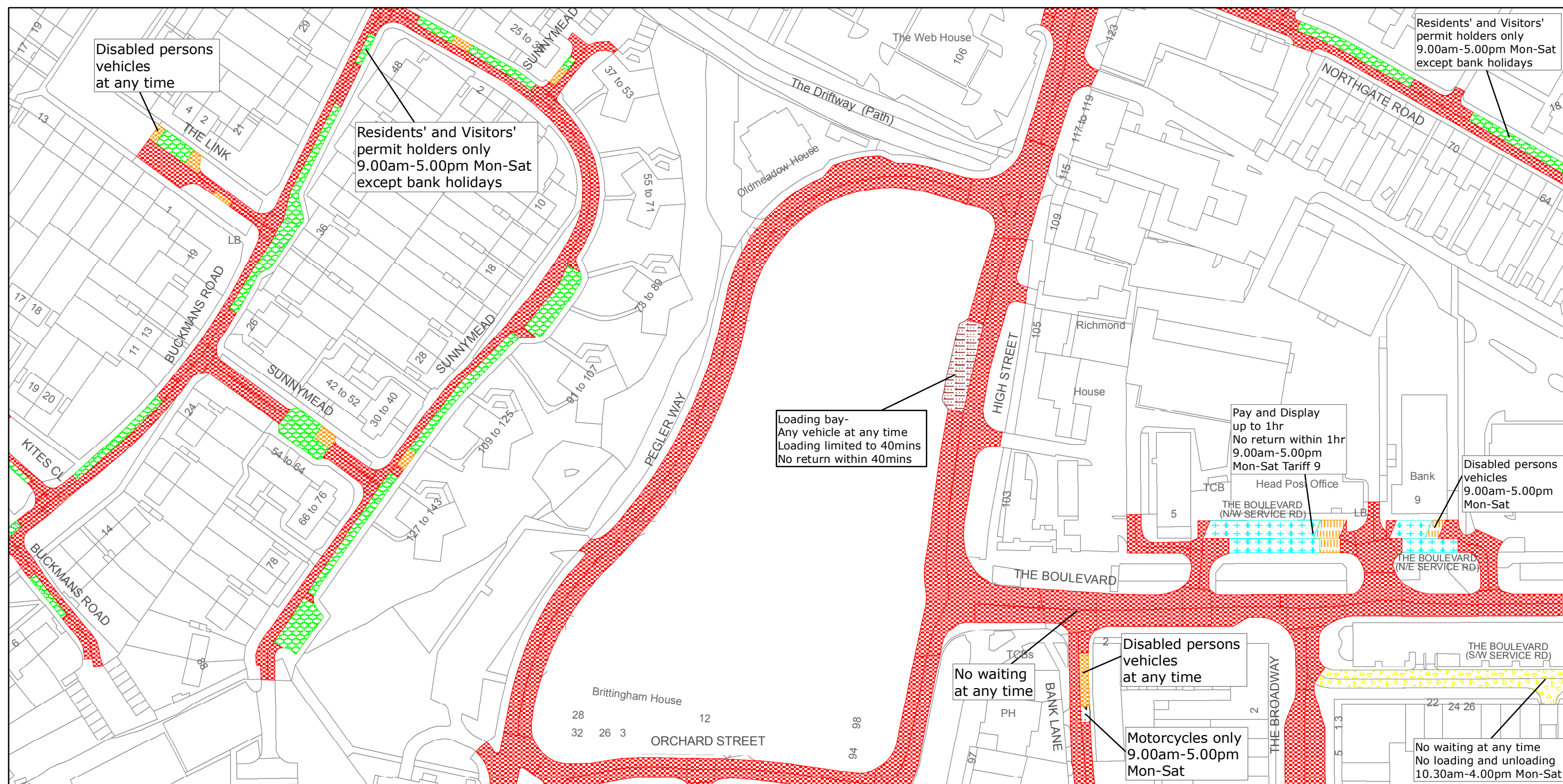

West Sussex County Council
Highways & Transport
The Grange
Tower Street
Chichester
West Sussex
PO19 1RH

CRAWLEY BOROUGH: NORTHGATE AND WEST GREEN WARDS

WAITING RESTRICTIONS

Reproduced from or based upon 2013 Ordnance Survey material with permission of the Controller of HMSO (c) Crown Copyright reserved.
Unauthorised reproduction infringes Crown copyright and may lead to prosecution or civil proceedings West Sussex County Council Licence No. 100023447

**TILE REF NO:
TQ2636NEN**

SHEET ISSUE NO 4

SHEET ACTIVE FROM -18/05/2015



**SCALE:
1:1250
at A3 size**

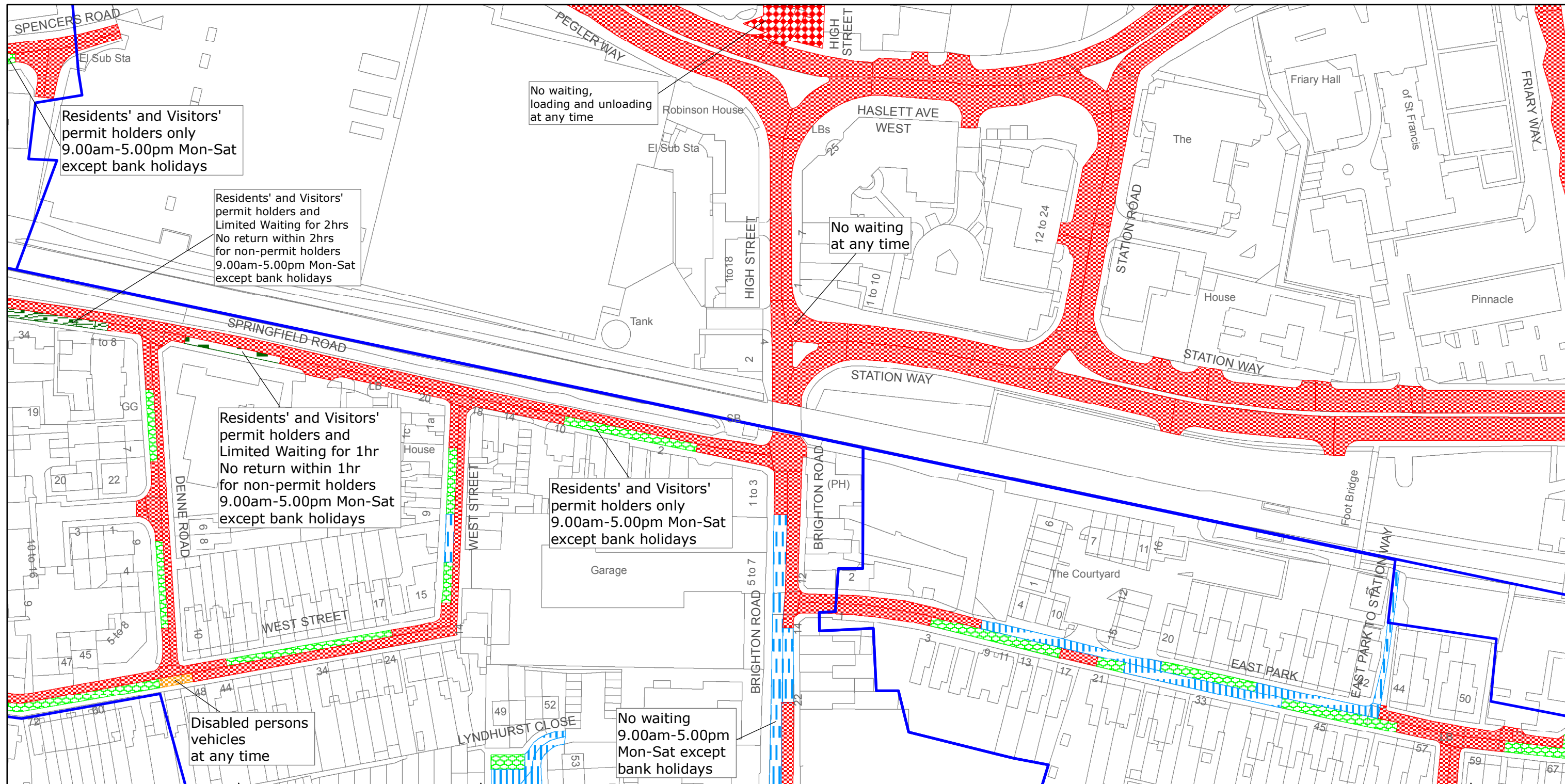

West Sussex County Council
Highways & Transport
The Grange
Tower Street
Chichester
West Sussex
PO19 1RH

CRAWLEY BOROUGH: NORTHGATE, SOUTHGATE
AND WEST GREEN WARDS

WAITING RESTRICTIONS

Reproduced from or based upon 2013 Ordnance Survey material with permission of the Controller of HMSO (c) Crown Copyright reserved.
Unauthorised reproduction infringes Crown copyright and may lead to prosecution or civil proceedings West Sussex County Council Licence No. 100023447

TILE REF NO:
TQ2636SEN

SHEET ISSUE NO 3
SHEET ACTIVE FROM - 18/05/2015



SCALE:
1:1250
at A3 size

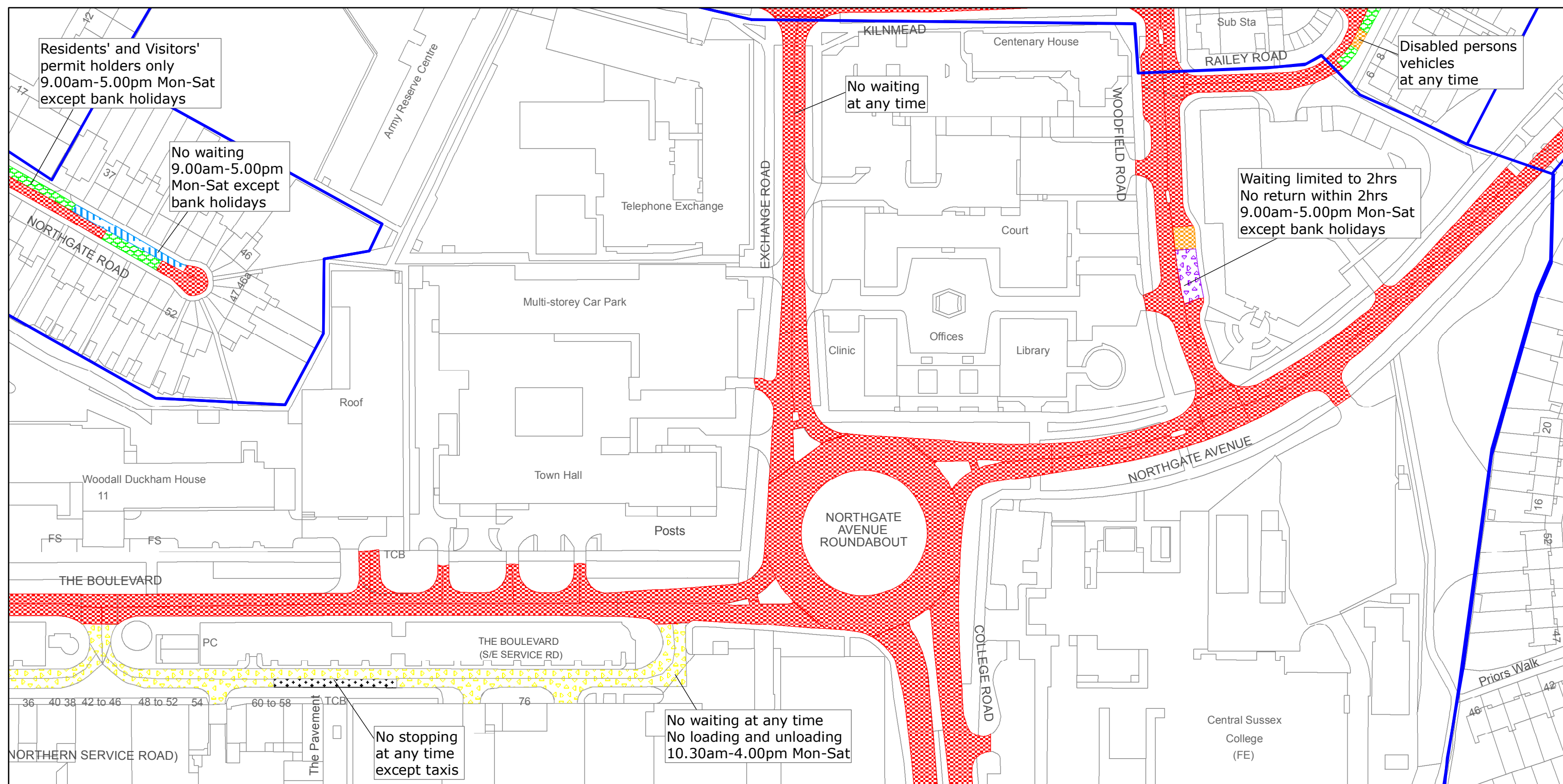

West Sussex County Council
Highways & Transport
The Grange
Tower Street
Chichester
West Sussex
PO19 1RH

CRAWLEY BOROUGH: NORTHGATE AND THREE BRIDGES WARDS

WAITING RESTRICTIONS

Reproduced from or based upon 2013 Ordnance Survey material with permission of the Controller of HMSO (c) Crown Copyright reserved.
Unauthorised reproduction infringes Crown copyright and may lead to prosecution or civil proceedings West Sussex County Council Licence No. 100023447

TILE REF NO:
TQ2736NWN

SHEET ISSUE NO 3
SHEET ACTIVE FROM - 18/05/2015



SCALE:
1:1250
at A3 size

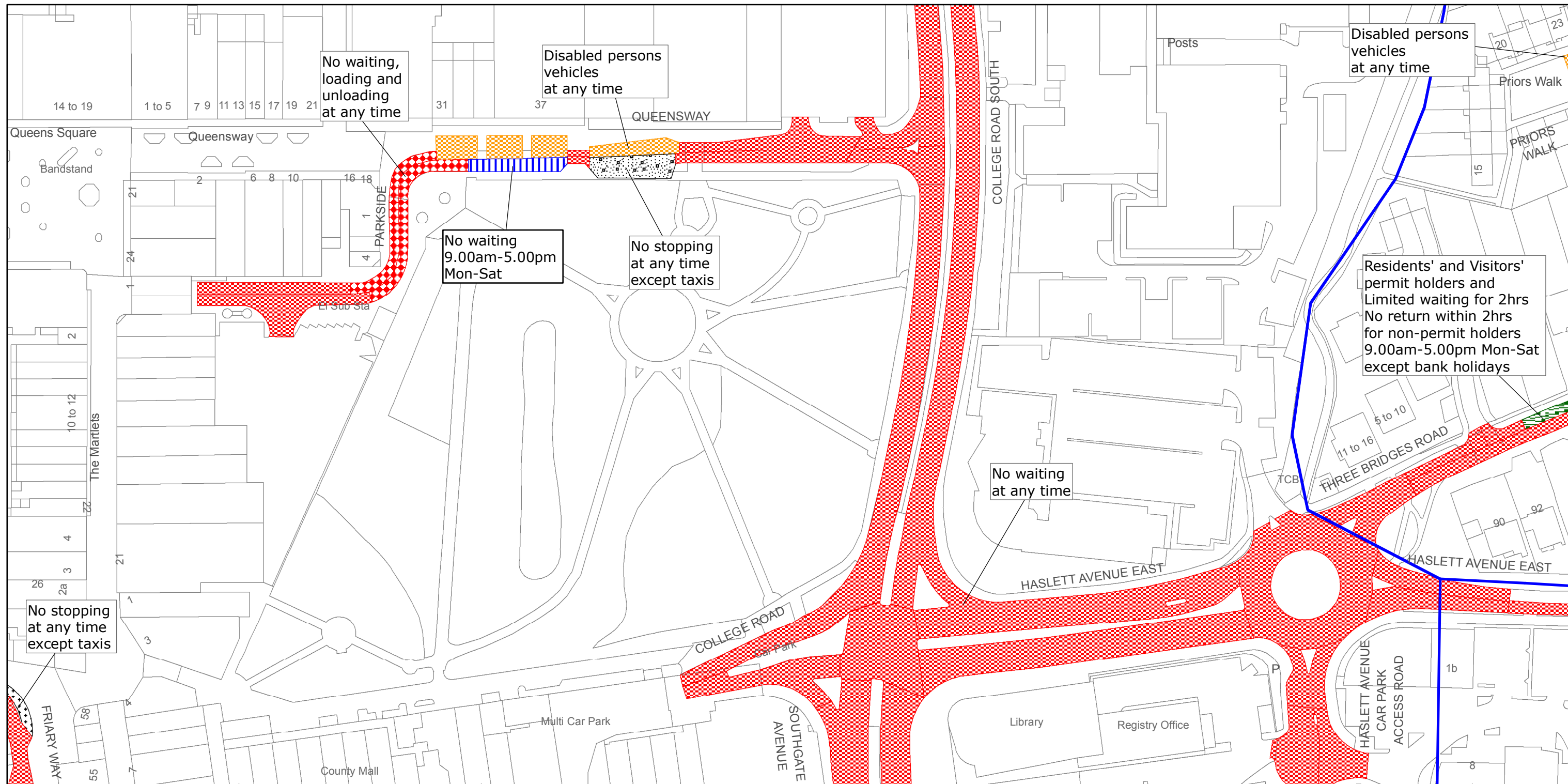

West Sussex County Council
Highways & Transport
The Grange
Tower Street
Chichester
West Sussex
PO19 1RH

CRAWLEY BOROUGH: THREE BRIDGES WARD

WAITING RESTRICTIONS

Reproduced from or based upon 2013 Ordnance Survey material with permission of the Controller of HMSO (c) Crown Copyright reserved.
Unauthorised reproduction infringes Crown copyright and may lead to prosecution or civil proceedings West Sussex County Council Licence No. 100023447

TILE REF NO:
TQ2736NWS

SHEET ISSUE NO 3

SHEET ACTIVE FROM - 18/05/2015



SCALE:
1:1250

at A3 size